



Project Summary

Organization:

Shibanee and Kamal Architects
www.total-environment.com

Location:

Pune, Maharashtra, India

Project Objective:

- Provide 2,000 square meters of space for classrooms, incubation rooms, auditorium, conference halls, and staff rooms.
- Save the massive tamarind tree that occupies the building site.
- Blend the building with its surrounding protected heritage structure.

Products used:

STAAD.Pro

Fast Facts

- Engineers analyzed curved walls with varied thickness and large openings, and simulated seismic behavior by performing dynamic analysis.
- Structural design compensated for irregular building shape with non-parallel column and wall alignments.
- The parametric model tools in STAAD.Pro allowed engineers to model all openings.
- STAAD.Pro's hybrid formulation simulated the curved wall as load bearing elements.
- Design analysis proved a conventional design alternative to be less economical and aesthetic than the unconventional structure ultimately chosen.

ROI

- Considering the curved wall as a load bearing element resulted in substantial cost savings.
- 3D visualization, flexible structural analysis, and reliable results delivered by STAAD.Pro produced major cost benefits.

Shibanee and Kamal Architects Uses STAAD.Pro to Analyze Unconventional Curved-wall Design

Bentley Software Helps Overcome Design Challenges of Innovative BHAU Institute

Nurturing Innovation

Shibanee and Kamal Architects, principal architects of Bangalore-based Total Environment Building Systems Pvt Ltd, designed the BHAU Institute of Innovation, Entrepreneurship, and Leadership (BIEL) for the College of Engineering, Pune. Located on the bank of river Mula in Maharashtra, India, the Institute is intended to nurture innovation, encourage entrepreneurship, and develop leadership. The INR 60 million building provides educational and research space within an unconventional, bi-directionally curved structure that blends in visually with the college's 160-year-old campus. The structural engineers used Bentley's STAAD.Pro® to deliver the precise analysis and visualization that enabled the evaluation of the curved wall itself as a load-bearing element. This substantially reduced the cost of the entire project.

Preserving Campus Heritage

Chartered in 1854, the College of Engineering, Pune is consistently ranked among the top 20 technical colleges in India. The college's newest institute will help students cultivate entrepreneurship qualities and support them while they set up new companies. The architects kept this mission in mind as they conceived a space that would integrate physical, social, and environmental considerations for a business incubator. The building had to fit on a site bounded on three sides by existing buildings, as well as blend organically into a campus declared to be one of the protected heritage structures in India. Perhaps the single greatest challenge, however, was to preserve a mature tamarind tree, which became the nexus of the design.

Shibanee and Kamal conceived a circular space built-up around the tree and spreading over a ground floor plus two floors for classrooms, incubation rooms, auditorium, conference facilities, and faculty rooms. The circular shape of the building not only preserved the mature tamarind tree but also fulfilled the requirements for good circulation space for the classrooms and auditorium. A bridge connecting the two ends of the building on either side of the tree made sure that not a single branch of the tree had to be cut.

The roof slab of the building was partly converted into a landscaped terrace garden, helping to integrate the building with its historic surroundings. A viewing gallery and amphitheater intended for recreation and relaxation overlook the river Mula, which flows along the northern side of the building. This alignment ensured that each habitable space has natural, glare-free north light and ventilation. In addition, the curvilinear change in elevation provided the maximum road width at the ground level, where the site was tightly constrained on three sides.

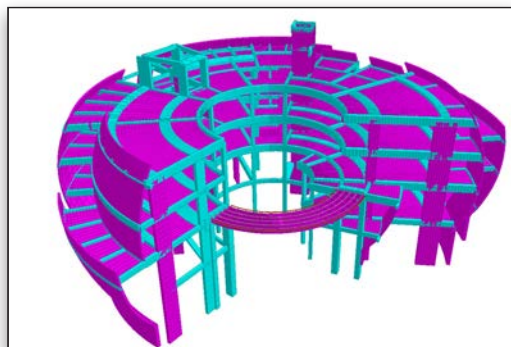

Rendered 3D structural model in STAAD.Pro.

The structure's unconventional shape posed several challenges during the design development stage, including:

- Feasibility of using bi-directionally curved walls to support large slabs and beams.
- Dynamics of the interaction of curved walls with slabs, beams, and columns.
- Predicting the behavior of curved concrete walls during earthquakes.
- Modeling and analyzing curved walls and irregularly shaped slabs as plate elements.
- Accommodating a large number of revisions in a short period of time.

“When the architect turns innovative, a structural engineer cannot lag behind. So we, too, responded positively by being innovative. Our engineers have mastered the art of modeling any complicated structure in STAAD.Pro. In this building, the main challenge before us was to employ the curved walls to support the slabs, and exploit their in-plane strength to resist seismic shears effectively. We could achieve whatever architects wanted and imagined.”

—Prakash Channappagoudar,
senior vice president,
structural design,
Shibanee and Kamal Architects

Find out about Bentley at: www.bentley.com

Contact Bentley
1-800-BENTLEY (1-800-236-8539)
Outside the US +1 610-458-5000

Global Office Listings
www.bentley.com/contact

Curved-wall Analysis and Design

The architects' design dictated that concrete walls were essential to support brick cladding on the exteriors and also to provide concrete form finish on the interiors. The main challenge for the structural engineers was to employ and exploit these walls to support gravity and lateral forces. First, the engineers had to answer numerous questions: Can bi-directionally curved walls of restricted thickness support slabs without excessive deflection? Can the structure resist the high seismic forces expected in this locality? Can large openings be made in the curved walls without compromising structural integrity? What about placing a curved wall on a set of beams that, in turn, rests on another curved wall?

The complexity of the BIEL building, which covered a built-up plan area of 2,128 square meters, demanded highly accurate modeling. STAAD.Pro was found to be the most versatile software for modeling and analyzing this structure, because of its flexible modeling environment, advanced features, powerful text editor, and interoperability. The Bentley software enabled the engineers to perform comprehensive and integrated finite element analysis, including analyzing for static loading; dynamic response; soil-structure interaction; and wind, earthquake, and moving loads.

STAAD.Pro allowed walls to be modeled as plate elements, and because of the software's hybrid formulation, it could simulate the behavior of both thick and thin plates. It also allowed the engineers to model openings within the walls. The engineers were able to perform both static and dynamic analysis to understand the behavior of the structure, including the steel bridge under different loading conditions. STAAD.Pro also helped the engineers design the walls using its innovative cut-line method, where the software outputs the design forces along a user-define cut line.

The 3D structural model was prepared easily by importing the vertical curved profile of the wall from AutoCAD into STAAD.Pro and then using the extrude, mirror, and copy features to model the curved wall.

Optimal Material Quantities

To meet the load bearing requirements of the structure, which included roof-top gardens in some areas, the final design called for 1,452 cubic meters of concrete and 178 metric tons

of steel. The curved walls alone called for 200 cubic meters of concrete and 47 metric tons of steel. While the quantity of steel required was quite high, the engineers were confident that their analysis yielded optimal quantities to reinforce the beams and slabs connected to the downward and laterally deflected curved wall. In addition, architectural constraints required minor axes of many columns to be oriented along the beam. In fact, one curved wall rests on the beams, acting as a load rather than a support.

The BIEL building is one of the rare structures where bi-directionally curved walls support slabs and beams, and the same beams and slabs prevent the wall from falling away.

The unconventional structure challenged the firm's engineers to analyze and design for all the expected load combinations, satisfying the limit states of safety and serviceability. It was essential to understand the exact behavior of the structure before designing the structural elements. STAAD.Pro helped the engineers to achieve this understanding.

The Unconventional Alternative

The unconventional design of the BIEL building may appear to be extravagant. But a more conventional design alternative that involved the use of cantilevers was, in fact, uneconomical and certainly less aesthetic. The architects chose the more challenging design and made it work. Consideration of the curved wall as a load bearing element (both gravity and seismic) ultimately resulted in substantial cost savings.

Major cost benefits during the design phase were realized through effective coordination among the architectural and service teams. This was due to the 3D visualization of the frame, the flexibility of the structural analysis, and the reliability of the results delivered by STAAD.Pro.

Designed to create an excellent ambience for innovation and learning, the BIEL building fits within the context of the campus' protected heritage. The scale of the structure and usage of materials do not disturb the existing skyline in the vicinity, and yet the new building has its own identity. Shibanee and Kamal Architects made every effort, from design through construction, to protect the prized tamarind tree. With this tree as its focal point, the building blends in with its surroundings through the application of natural cladding materials and terrace gardens.